

Boardwalk

Coronation Road

SOUTHVILLE

APPROXIMATE FLOOR AREA
48.2 SQM / 518 SQFT

BOOK A VIEWING
01179 898 222
hello@boardwalkpropertyco.com

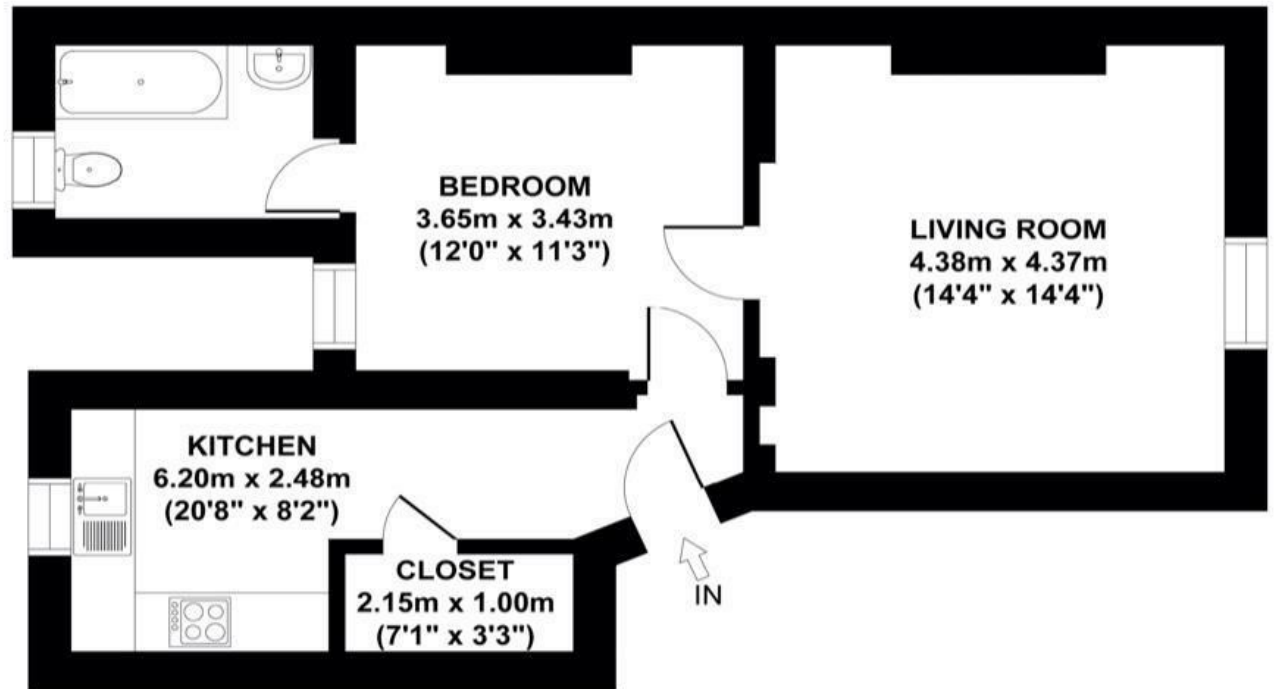

GROUND FLOOR
GROSS INTERNAL
FLOOR AREA 48.16 SQ M

Illustrations are for reference purposes only, measurements are approximate, not to scale.

Boardwalk

Coronation Road

SOUTHVILLE, BRISTOL



£260,000



1 Bedrooms



BS3 1RF



1 Bathrooms

"I've really loved living on Coronation Road. I was instantly drawn to its history and character; the big sash windows and high ceilings make it feel light and spacious for a one bed flat and it's great having some outdoor space to call your own. All the neighbours in the building are friendly and accommodating and the location was great for me when I was getting to know a new city. I love to wander down to Mark's Bread on North Street for a loaf and a coffee in the morning or to start my day at Bristol Pilates studio where there's a real sense of community. Being able to go for an evening walk or run around the harbour or meet friends for an evening beer to watch the sun go down at Baltic Wharf steps still makes me feel like I'm on holiday, even though I've been here for years now. You're spoilt for choice for eating and drinking out in the neighbourhood. Dinner at Sonny Stores, brunch at Tin Can, drinks at The Old Bookshop or Friendly Records or just a Dogtown hot dog at Whapping Wharf are some of my favourites. I really appreciate being able to walk or cycle to Ashton Court or Leigh Woods so

